



EPM-H400S 系列概述

一. 电源规格:

电源型号 (MODEL)	输入(VAC)	输出 (VDC)	保护功能 (PROTECTION)	尺寸 (SIZE) MM
EPM-H400S3.3	176-240VAC	3.3V/60A	SCP/OCP/OTP/OVP	227mm*115mm*50mm
EPM-H400S5	176-240VAC	5V/65A	SCP/OCP/OTP/OVP	227mm*115mm*50mm
EPM-H400S6.5	176-240VAC	6.5V/60A	SCP/OCP/OTP/OVP	227mm*115mm*50mm
EPM-H400S7.5	176-240VAC	7.5V/53A	SCP/OCP/OTP/OVP	227mm*115mm*50mm
EPM-H400S12	176-240VAC	12V/33A	SCP/OCP/OTP/OVP	227mm*115mm*50mm
EPM-H400S15	176-240VAC	15V/27A	SCP/OCP/OTP/OVP	227mm*115mm*50mm
EPM-H400S24	176-240VAC	24V/17A	SCP/OCP/OTP/OVP	227mm*115mm*50mm
EPM-H400S28	176-240VAC	28V/14A	SCP/OCP/OTP/OVP	227mm*115mm*50mm
EPM-H400S36	176-240VAC	36V/11A	SCP/OCP/OTP/OVP	227mm*115mm*50mm
EPM-H400S40	176-240VAC	40V/10A	SCP/OCP/OTP/OVP	227mm*115mm*50mm
EPM-H400S48	176-240VAC	48V/8.5A	SCP/OCP/OTP/OVP	227mm*115mm*50mm
EPM-H400S63	176-240VAC	63V/6.4A	SCP/OCP/OTP/OVP	227mm*115mm*50mm

二. 系列特性:

Features:

AC input range selectable by switch

Compact size

Protections: SCP /OCP/ OTP /OVP

Forced air cooling by built-in DC fan

Low cost, high reliability, high efficiency

100% full load burn-in test

1 years warranty

三. 产品外观:



net weight: 1060g

四. 工作温度, 输出功率曲线:

Temperature- load curve

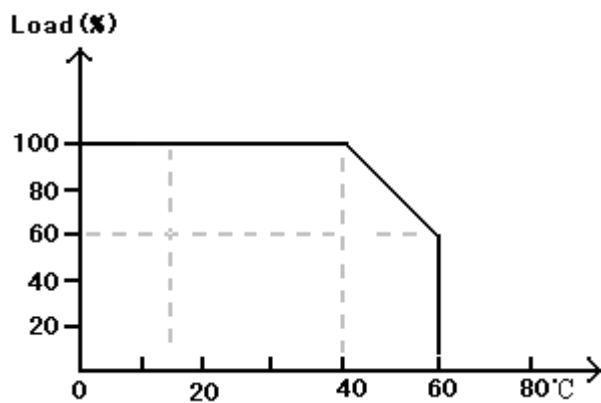

五. 测试标准:

EMC DATA

1、 EMI

RE/CE	EN55022 CLASS A
Harmonics Current	EN61000-3-2

2、 EMS

ESD	EN61000-4-2	Air:8KV Contact:4KV	Criteria A
RS	EN61000-4-3	80MHz~1GHz 3V/m	Criteria A
EFT	EN61000-4-4	5KHz AC=1KV	Criteria A
Surge Test	EN61000-4-5	1.2/50us AC:±2KV 8/50us	Criteria A
CS	EN61000-4-6	0.15MHz-80MHz 3V/m	Criteria A

Voltage dips	EN61000-4-8	30% 10ms 60% 100ms >95% 5000ms	Criteria A
Power Frequency Magnetic Field	EN61000-4-11	50Hz 30A/m	Criteria A
RF Electromagnetic Field pulse modulated	ENV50204	900±5MHz 200Hz 3V/m, 50%Duty cycle	Criteria A

六. 安装尺寸:

build in dimension

unit: mm

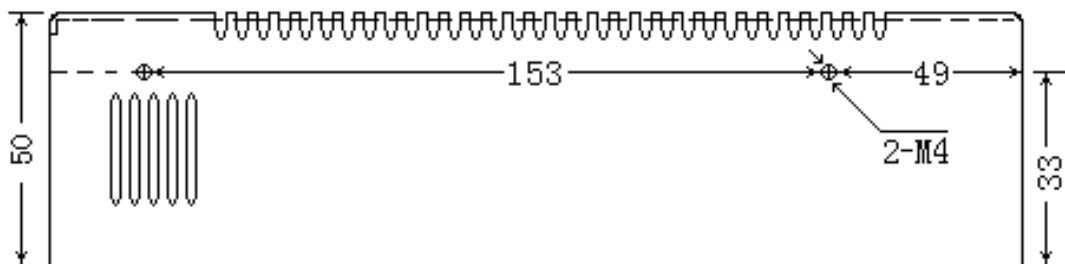
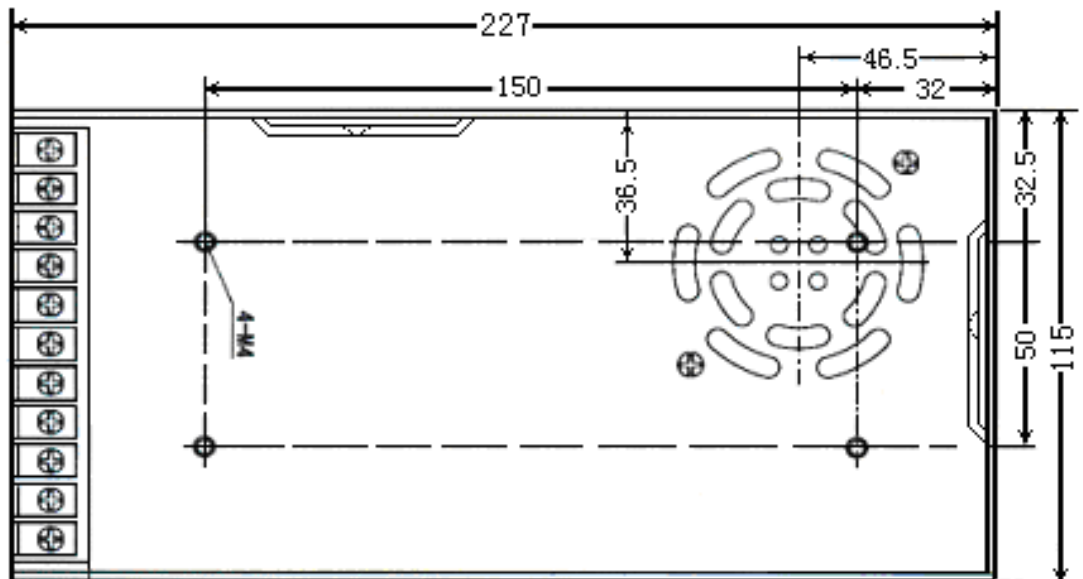
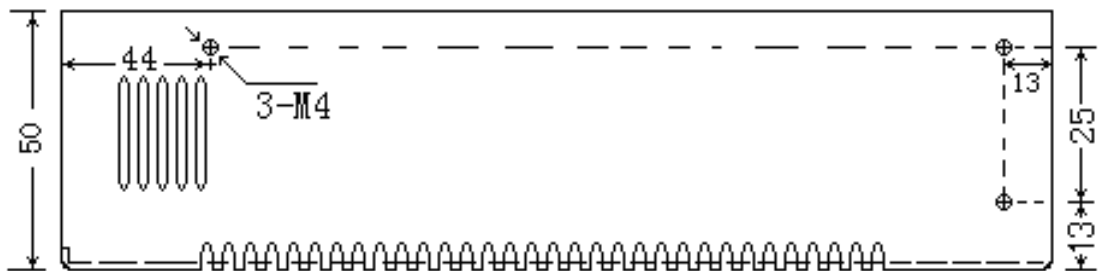



七. 标签:

Spec Label

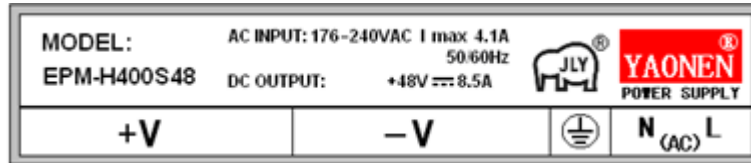

ADJ:OUTPUT ADJ



八.包装:

Packing unit: mm

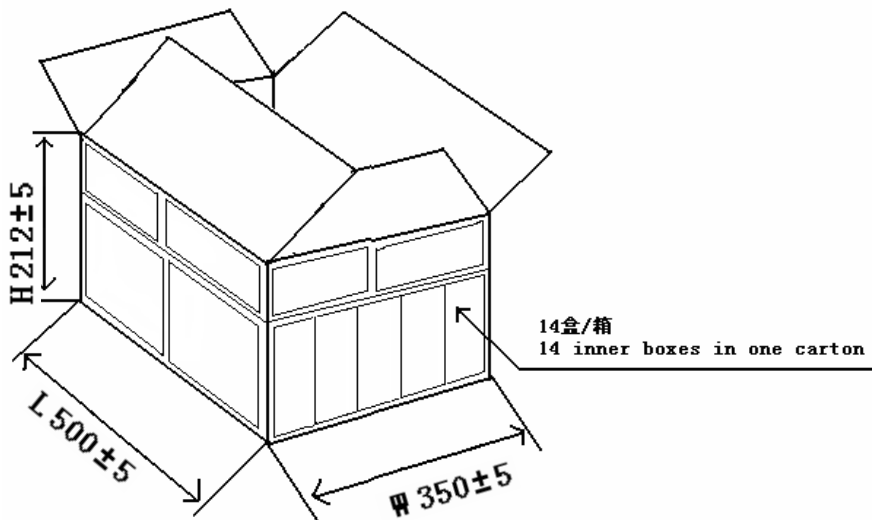

Inner Box plane

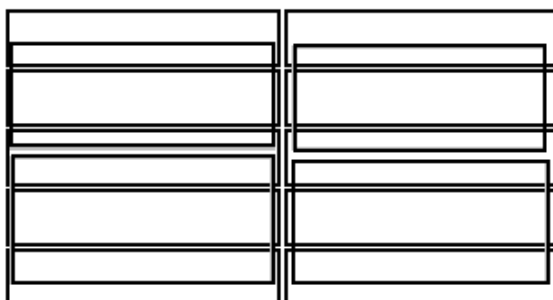

solid

