



UM-U500S 系列概述

一. 电源规格:

电源型号 (MODEL)	输入 (VAC)	输出 (VDC)	保护功能 (PROTECTION)	尺寸 (SIZE) MM
UM-U500S24	100~240VAC	24V/21A	SCP/OCP/OVP/OTP	176mm*92mm*40mm
UM-U500S28	100~240VAC	28V/18A	SCP/OCP/OVP/OTP	176mm*92mm*40mm
UM-U500S36	100~240VAC	36V/14A	SCP/OCP/OVP/OTP	176mm*92mm*40mm
UM-U500S45	100~240VAC	45V/11A	SCP/OCP/OVP/OTP	176mm*92mm*40mm
UM-U500S48	100~240VAC	48V/11A	SCP/OCP/OVP/OTP	176mm*92mm*40mm
UM-U500S52	100~240VAC	52V/10A	SCP/OCP/OVP/OTP	176mm*92mm*40mm
UM-U500S63	100~240VAC	63V/8A	SCP/OCP/OVP/OTP	176mm*92mm*40mm

二. 系列特性:

Features

Universal AC input/Full range;

Built-in Active PFC;

PF: >0.97@230VAC; >0.99@110VAC full load;

Soft switch technology, the efficiency > 93% (type)

Protections:SCP/OCP/OVP/OTP;

Small volume, base plate, U type shell;

Low cost,high reliability,high efficiency;

<300W Free air convection, ≥300W 40CFM forced air cooling by DC FAN;

Single way output, can bring 400VDC output

100%full load bum-in test;

3 ears warranty.

三. 产品外观:



net weight: 830.2g

Connection: INPUT: TB762-01-3P (7.62MM-3P); OUT PUT: (MCU-04525-M5) Copper Post

四. 工作温度，输出功率曲线以及负载曲线图:

Temperature- load curve

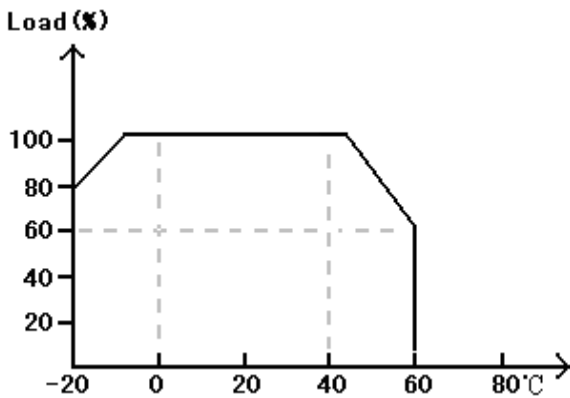

Input voltage- load curve

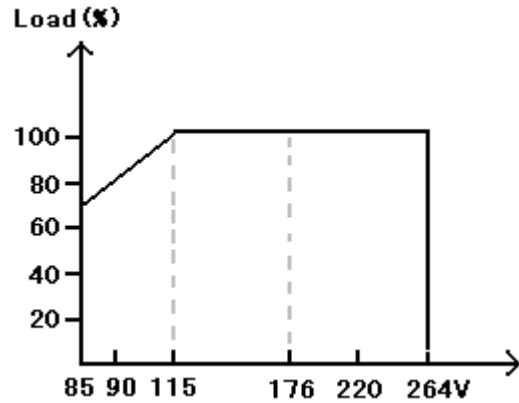

五. 测试标准:

EMC DATA :

1、 EMI

RE/CE	EN55022 CLASS A
Harmonics Current	EN61000-3-2

2、 EMS

ESD	EN61000-4-2	Air:8KV Contact:4KV	Criteria A
RS	EN61000-4-3	80MHz~1GHz 3V/m	Criteria A
EFT	EN61000-4-4	5KHz AC=1KV	Criteria A



Surge Test	EN61000-4-5	1. 2/50us AC: ±2KV 8/50us	Criteria A
CS	EN61000-4-6	0. 15MHz-80MHz 3V/m	Criteria A
Voltage dips	EN61000-4-8	30% 10ms 60% 100ms >95% 5000ms	Criteria A
Power Frequency Magnetic Field	EN61000-4-11	50Hz 30A/m	Criteria A
RF Electromagnetic Field pulse modulated	ENV50204	900±5MHz 200Hz 3V/m, 50%Duty cycle	Criteria A

六. 安装尺寸:

build in dimension

unit: mm

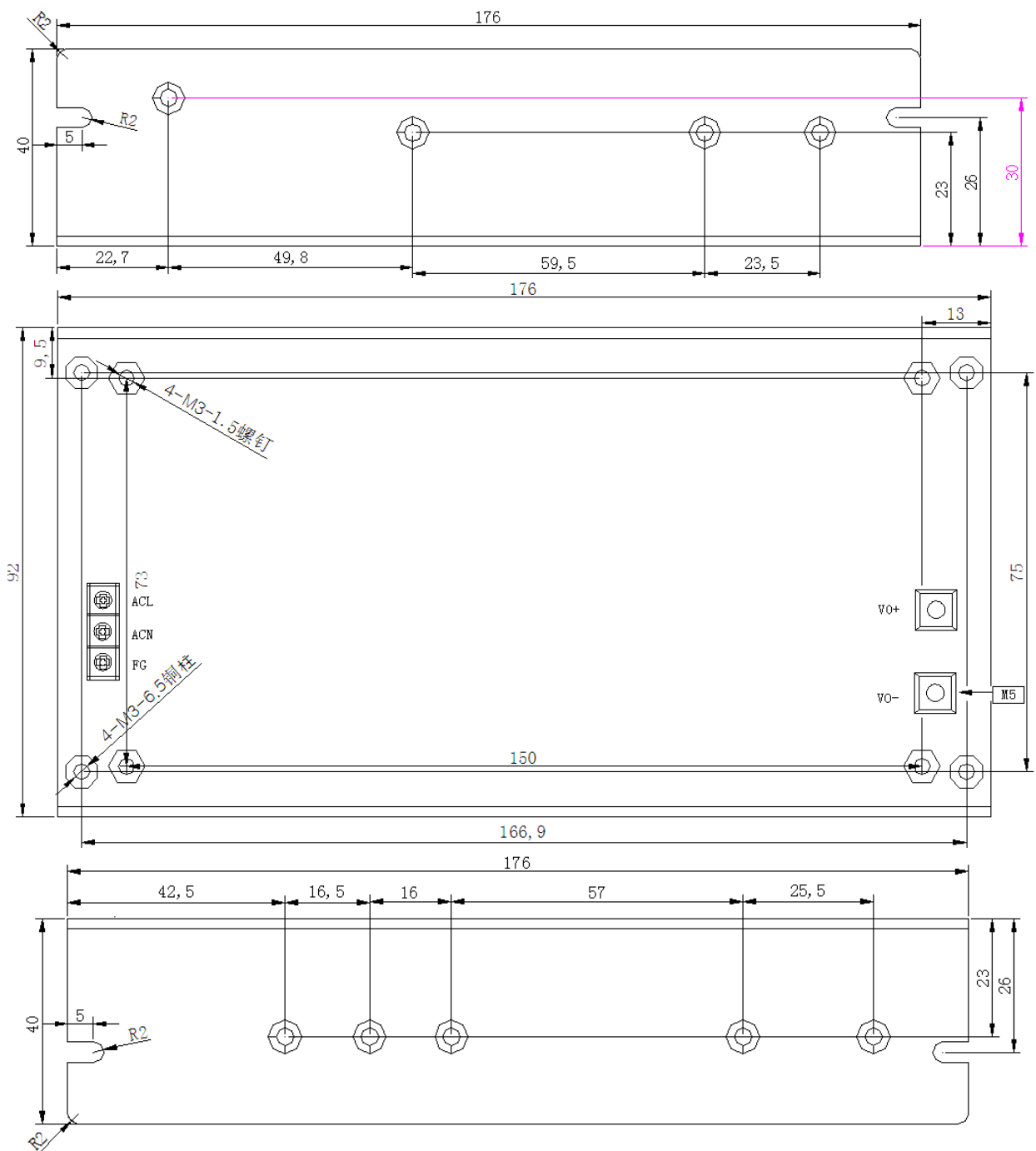

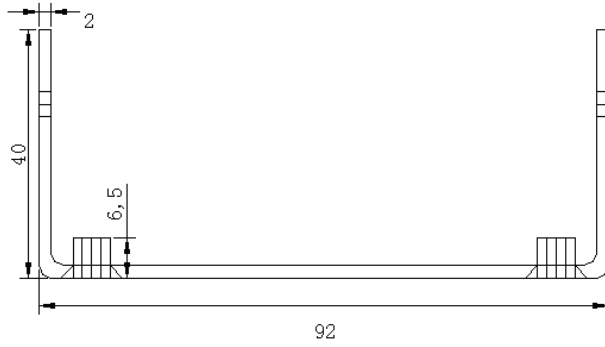

七. 标签:

Spec Label

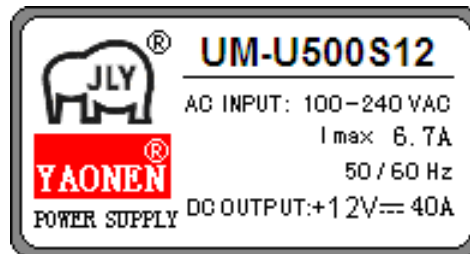

Connector define

ACL ACN FG

VO- VO+



八. 包装:

Packing unit: mm

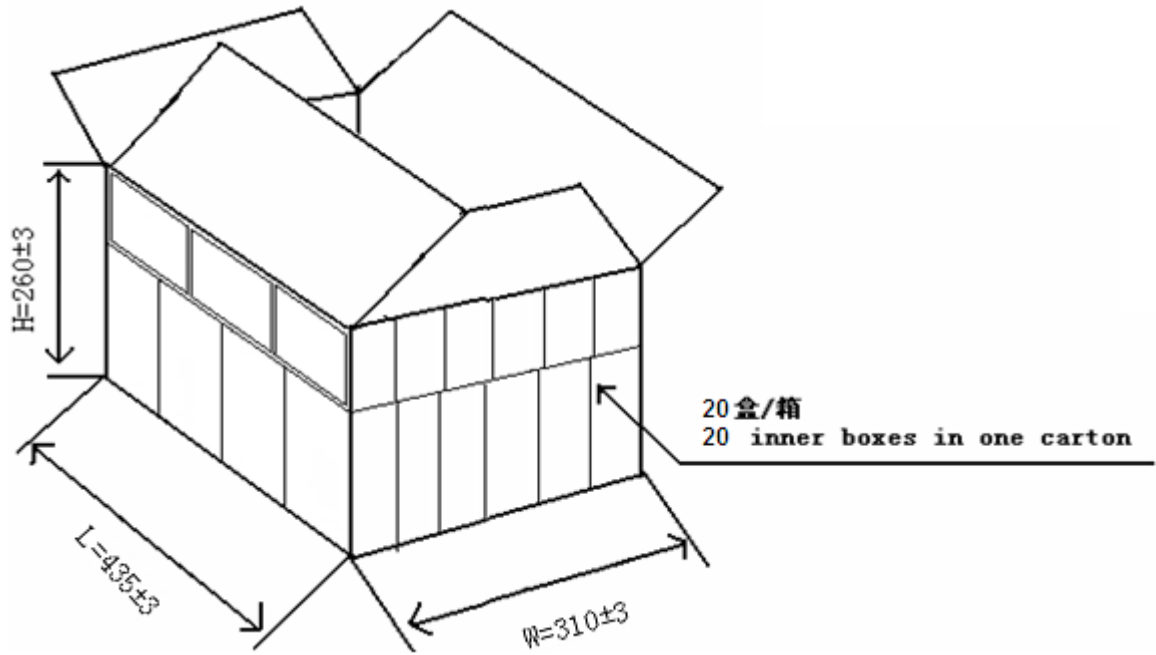

Inner Box plane

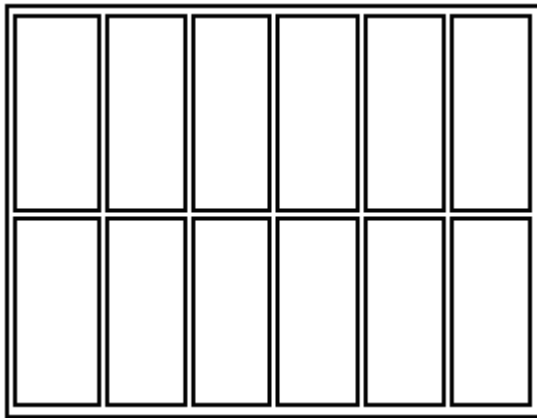

solid

